

U 260-C

Time &
Terminal

Attendance



The firmware of U260-C has been upgraded to the new firmware, it has new features like stunning GUI, more stability, faster matching speed and better expandability.

Users can easily manage data by networking U260-C via RS232/485, TCP/IP, and USB-host/client. Most importantly, all the functions can still operate in a networking state. It also supports data backup and retrieve to avoid the risk of accidental deletion.

Feature

Remarkable user experience

- Intuitive and stunning UI designed with the most popular and internationalized element.
- Interface operation adopts modularized hierarchical design.
- Simpler, better and more logical.
- Faster matching speed: Less than 0.5 second.
- Great user interactivity.

Enhanced features and performance

- Multi-languages.
- Data backup and retrieve.
- Advanced User ID consisted of letters and numbers.
- Chip encryption for firmware protection.
- Compatibility with various types of USB flash disks, ADMS and former SDK.

Excellent expandability

- Easy to extend functions and customize customers' requirements.

Specifications

Fingerprint Capacity	3000
ID Card Capacity	10,000 (Optional)
Record Capacity	100,000
Display	3-inch Screen
Communication	RS232/485, TCP/IP, USB-host/client
Standard Functions	Work code, SMS, DST, Webserver, Scheduled-bell, ADMS Self-Service Query, Automatic Status Switch, T9 Input
Optional Functions	ID/Mifare/HID, External Printer and Bell, Photo ID, USB-client
Software	BioTime
Power Supply	DC 5V 2A
Verification Speed	≤0.5 Sec.
Operating Temp.	0 °C- 45 °C
Operating Humidity	20%-80%
Dimension	192.3 × 138.8 × 42.7mm (Length × Width × Thickness)
Net Weight	1.10 kg

Configuration

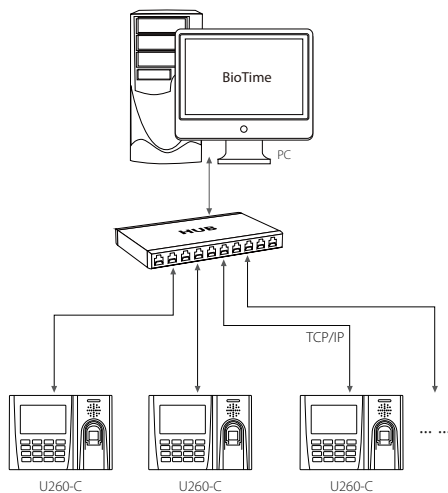

What's in the Box

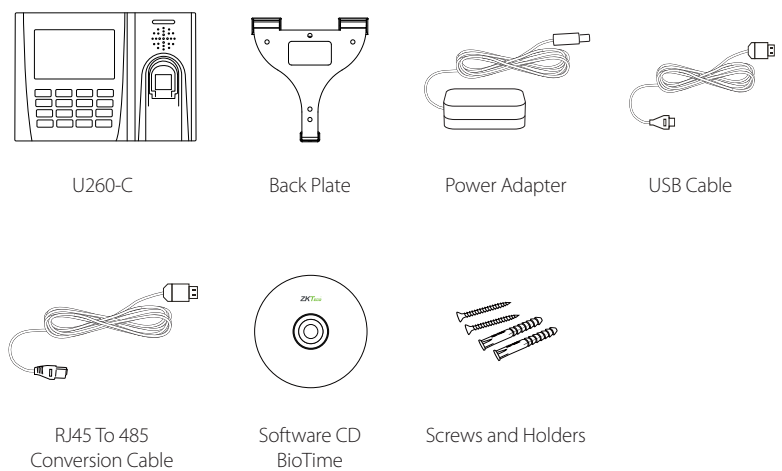

ZKTeco Middle East
E-mail: zk_me@zkteco.com
www.zkteco.me